

SHEET 9: CULVERT PLAN

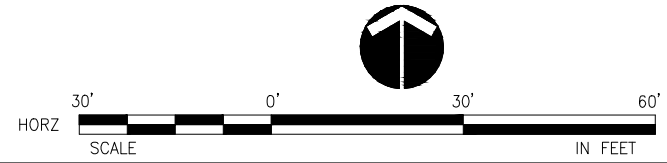
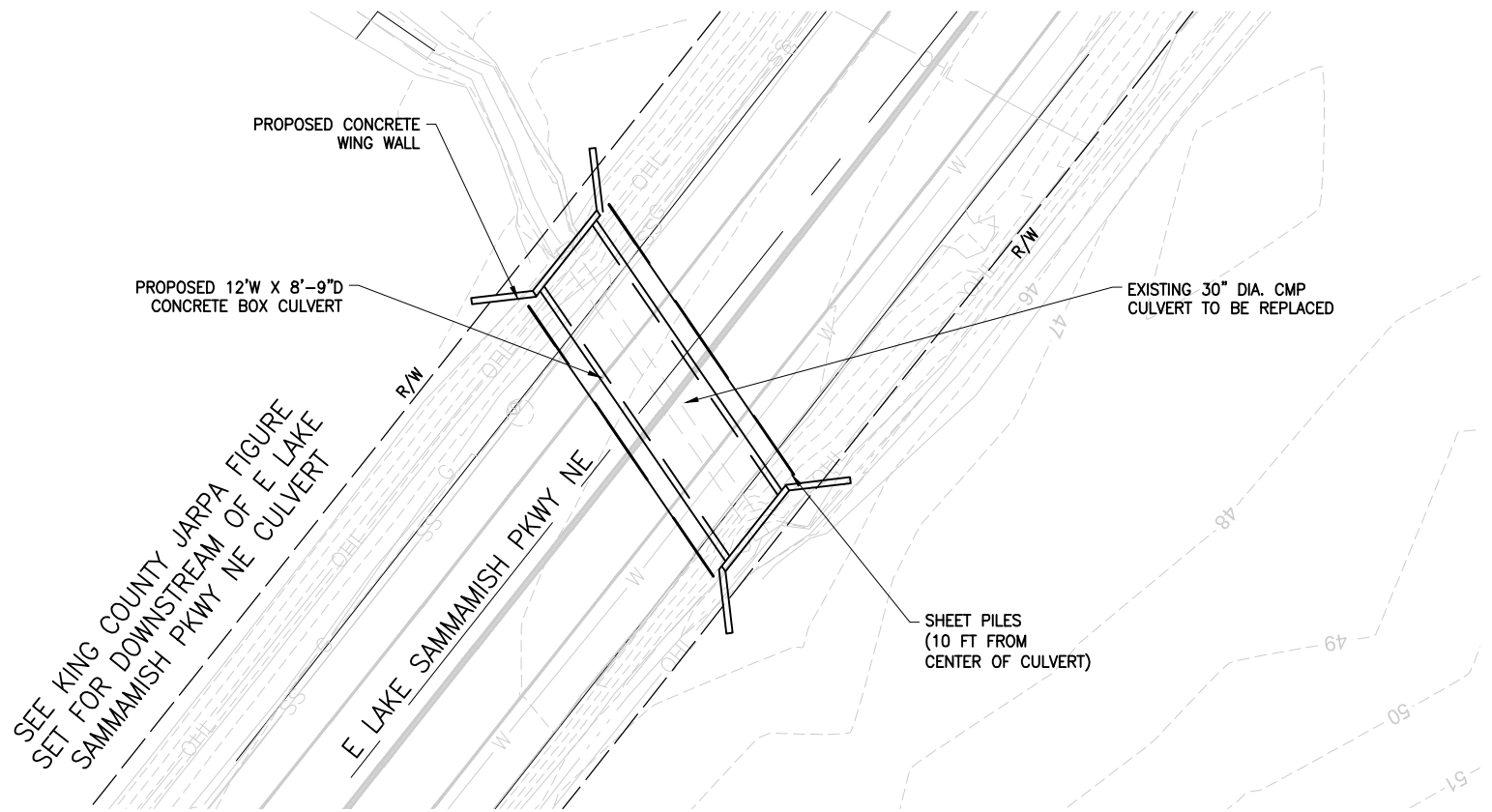

DATE: October 2017

APPLICANT: CITY OF SAMMAMISH

REFERENCE #:

ADJACENT PROPERTY OWNERS:  
SEE JARPA ATTACHMENT C

PURPOSE: ENVIRONMENTAL  
ENHANCEMENT

LAT/LONG: 47.6100N / 122.0703W

SITE LOCATION ADDRESS:  
PORTIONS OF SECTION 32,  
TOWNSHIP 25N, RANGE 06E

PROPOSED PROJECT:  
ZACKUSE CREEK FISH PASSAGE PROJECT

WATER BODY: LAKE SAMMAMISH/ZACKUSE CREEK  
NEAR: SAMMAMISH

COUNTY: KING STATE: WA

SHEET 10: CULVERT DETAILS (PROFILE)

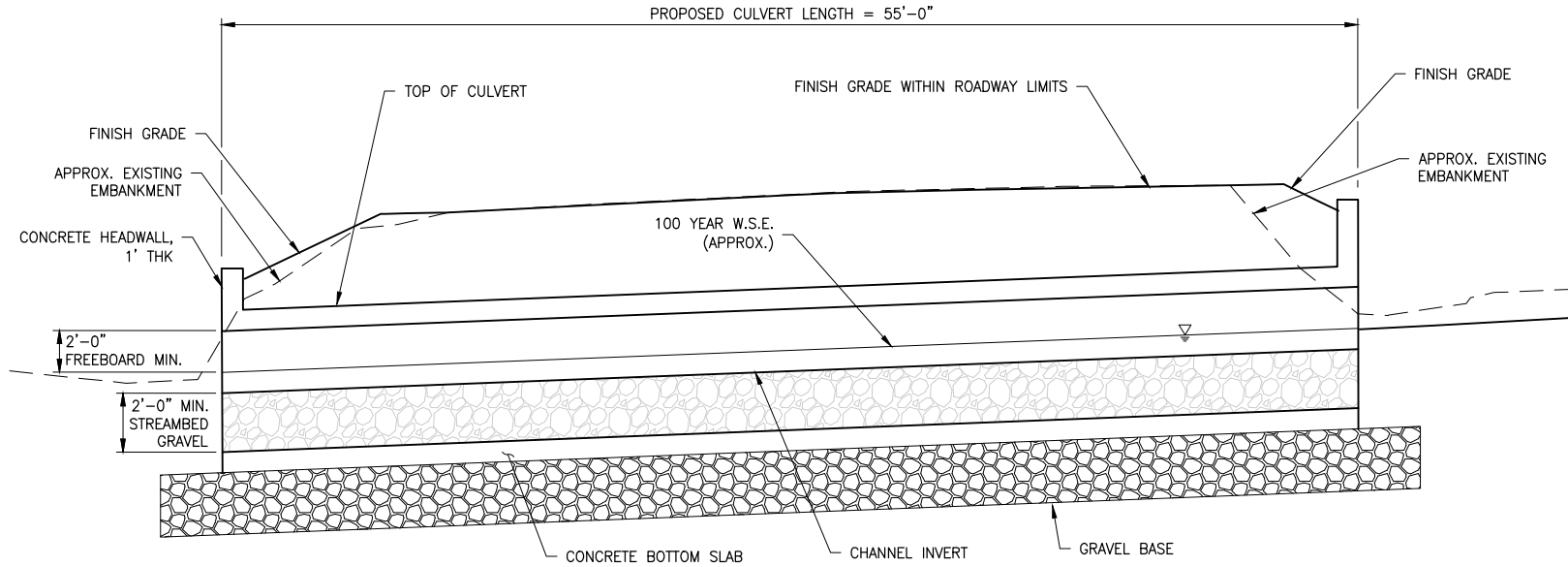

NOT TO SCALE

CULVERT PROFILE

DATE: October 2017

APPLICANT: CITY OF SAMMAMISH

PURPOSE: ENVIRONMENTAL ENHANCEMENT

PROPOSED PROJECT: ZACKUSE CREEK FISH PASSAGE PROJECT

REFERENCE #:

LAT/LONG: 47.6100N / 122.0703W

ADJACENT PROPERTY OWNERS: SEE JARPA ATTACHMENT C

SITE LOCATION ADDRESS: PORTIONS OF SECTION 32, TOWNSHIP 25N, RANGE 06E

WATER BODY: LAKE SAMMAMISH/ZACKUSE CREEK NEAR: SAMMAMISH

COUNTY: KING STATE: WA

OF 20

# SHEET 11: CULVERT DETAILS (SECTION)

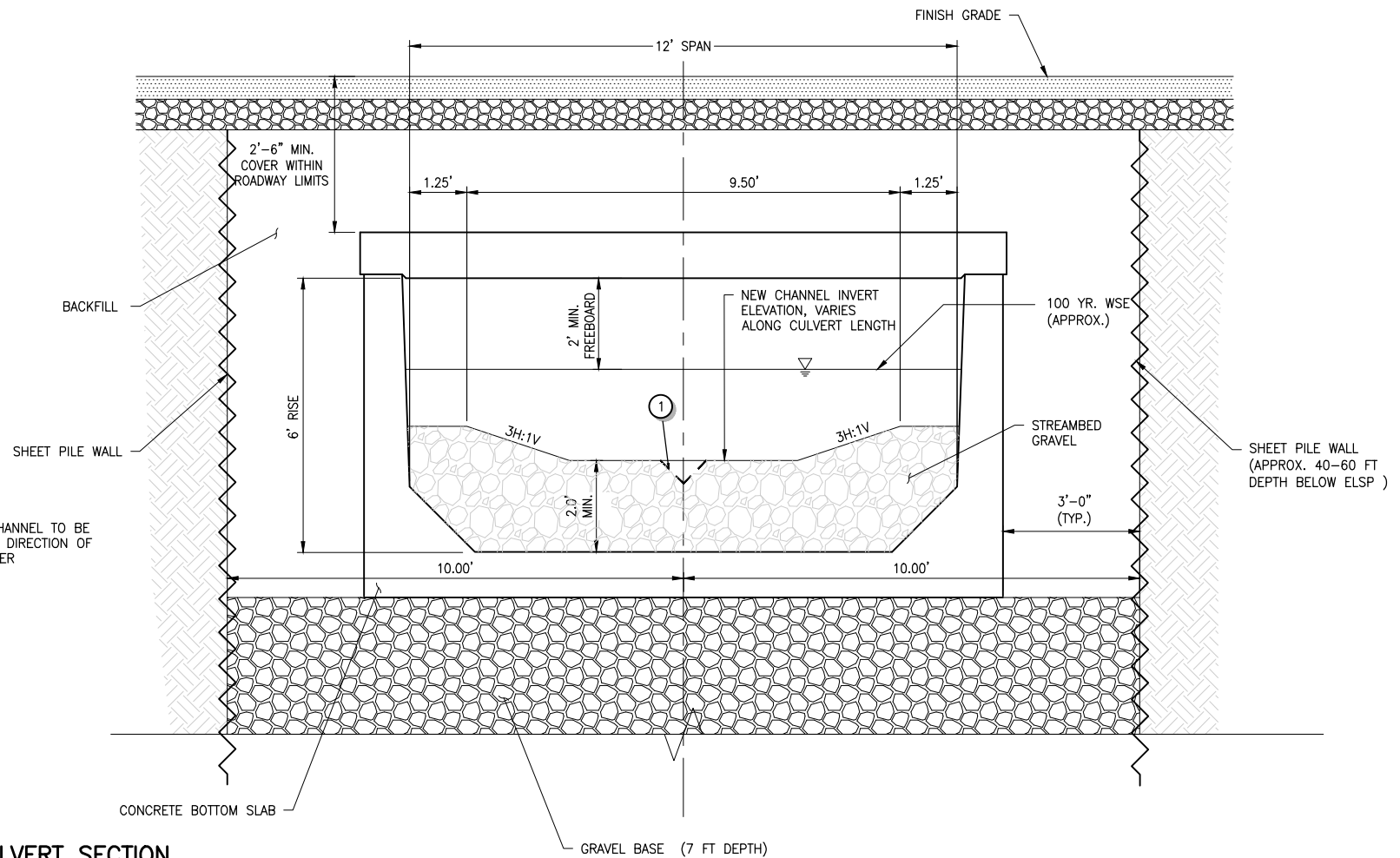

**NOTES**  
 1. LOW FLOW CHANNEL TO BE INSTALLED AT DIRECTION OF FIELD ENGINEER

## TYPICAL CULVERT SECTION

DATE: October 2017

APPLICANT: CITY OF SAMMAMISH

PURPOSE: ENVIRONMENTAL ENHANCEMENT

PROPOSED PROJECT: ZACKUSE CREEK FISH PASSAGE PROJECT

REFERENCE #:

LAT/LONG: 47.6100N / 122.0703W

ADJACENT PROPERTY OWNERS: SEE JARPA ATTACHMENT C

SITE LOCATION ADDRESS: PORTIONS OF SECTION 32, TOWNSHIP 25N, RANGE 06E

WATER BODY: LAKE SAMMAMISH/ZACKUSE CREEK  
 NEAR: SAMMAMISH

COUNTY: KING STATE: WA

SHEET 13: WETLAND AND STREAM AREAS OF IMPACT (1 OF 3)

ACTIVITY	WETLAND NAME	IMPACT AREA (SF)	IMPACT VOLUME (CY)	DURATION OF IMPACT
CONVERSION - WETLAND TO STREAM HABITAT	WETLAND 2	5930	530	PERMANENT
CUT	WETLAND 2	500	10	PERMANENT
FILL	WETLAND 2	1500	85	PERMANENT
CLEARING & RESTORATION	WETLAND 2	5523	-	TEMPORARY
CUT	WETLAND 1/26A	1500	0.5	PERMANENT
FILL	WETLAND 1/26A	1500	100	PERMANENT

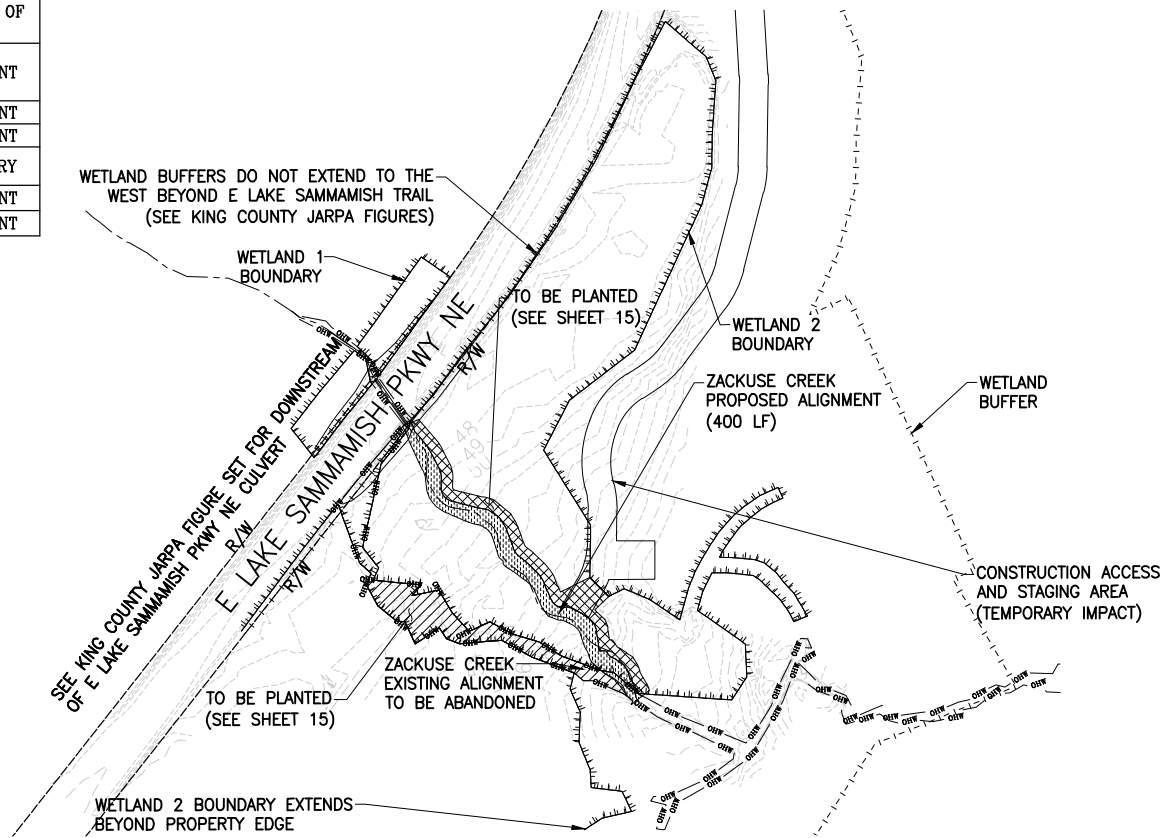

LEGEND

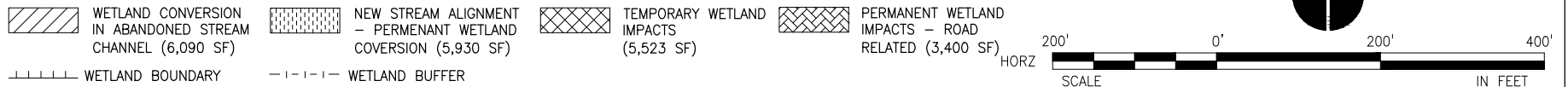

DATE: October 2017

APPLICANT: CITY OF SAMMAMISH

PURPOSE: ENVIRONMENTAL ENHANCEMENT

PROPOSED PROJECT: ZACKUSE CREEK FISH PASSAGE PROJECT

REFERENCE #:

LAT/LONG: 47.6100N / 122.0703W

ADJACENT PROPERTY OWNERS: SEE JARPA ATTACHMENT C

SITE LOCATION ADDRESS: PORTIONS OF SECTION 32, TOWNSHIP 25N, RANGE 06E

WATER BODY: LAKE SAMMAMISH/ZACKUSE CREEK  
NEAR: SAMMAMISH  
COUNTY: KING STATE: WA

SHEET 14: WETLAND AND STREAM AREAS OF IMPACT (2 OF 3)

	AREA (SF)	VOLUME (CY)
WETLAND 1 CUT	-	0.5
WETLAND 1 FILL	-	100
WETLAND 1 NET FILL	1,500	99.5
WETLAND 2 CUT	-	541.4
WETLAND 2 FILL	-	86.3
WETLAND 2 NET FILL	15,330	455.1

	PRE-CONSTRUCTION	POST-CONSTRUCTION
WETLAND 1 (SF)	4,617	4,617
WETLAND 2 (SF)	157,350	157,970
ZACKUSE CREEK (LF)	530	400

WETLAND BUFFERS DO NOT EXTEND TO THE WEST BEYOND E LAKE SAMMAMISH TRAIL (SEE KING COUNTY JARPA FIGURES)

SEE KING COUNTY JARPA FIGURE SET FOR DOWNSTREAM OF E LAKE SAMMAMISH PKWY NE CULVERT

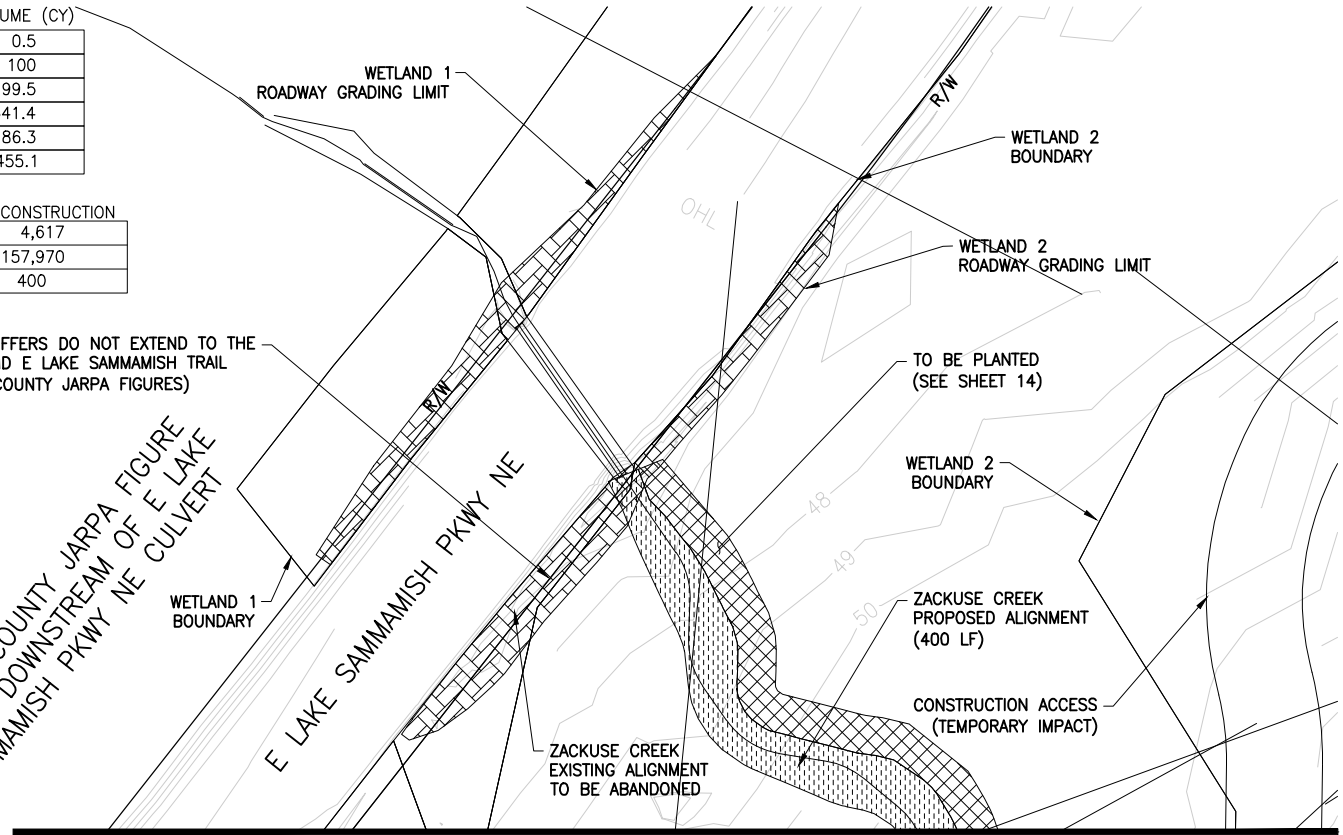

LEGEND

- WETLAND CONVERSION IN ABANDONED STREAM CHANNEL (6,090 SF)
- NEW STREAM ALIGNMENT - PERMANENT WETLAND COVERAGE (5,930 SF)
- TEMPORARY WETLAND IMPACTS (5,523 SF)
- PERMANENT WETLAND IMPACTS - ROAD RELATED (3,400 SF)
- WETLAND BOUNDARY
- WETLAND BUFFER



MATCH LINE SEE SHEET 14

DATE: October 2017

APPLICANT: CITY OF SAMMAMISH

PURPOSE: ENVIRONMENTAL ENHANCEMENT

PROPOSED PROJECT: ZACKUSE CREEK FISH PASSAGE PROJECT

REFERENCE #:

LAT/LONG: 47.6100N / 122.0703W

WATER BODY: LAKE SAMMAMISH/ZACKUSE CREEK

ADJACENT PROPERTY OWNERS: SEE JARPA ATTACHMENT C

SITE LOCATION ADDRESS: PORTIONS OF SECTION 32, TOWNSHIP 25N, RANGE 06E

NEAR: SAMMAMISH

COUNTY: KING STATE: WA

SHEET 15: WETLAND AND STREAM AREAS OF IMPACT (3 OF 3)

MATCH LINE SEE SHEET 13

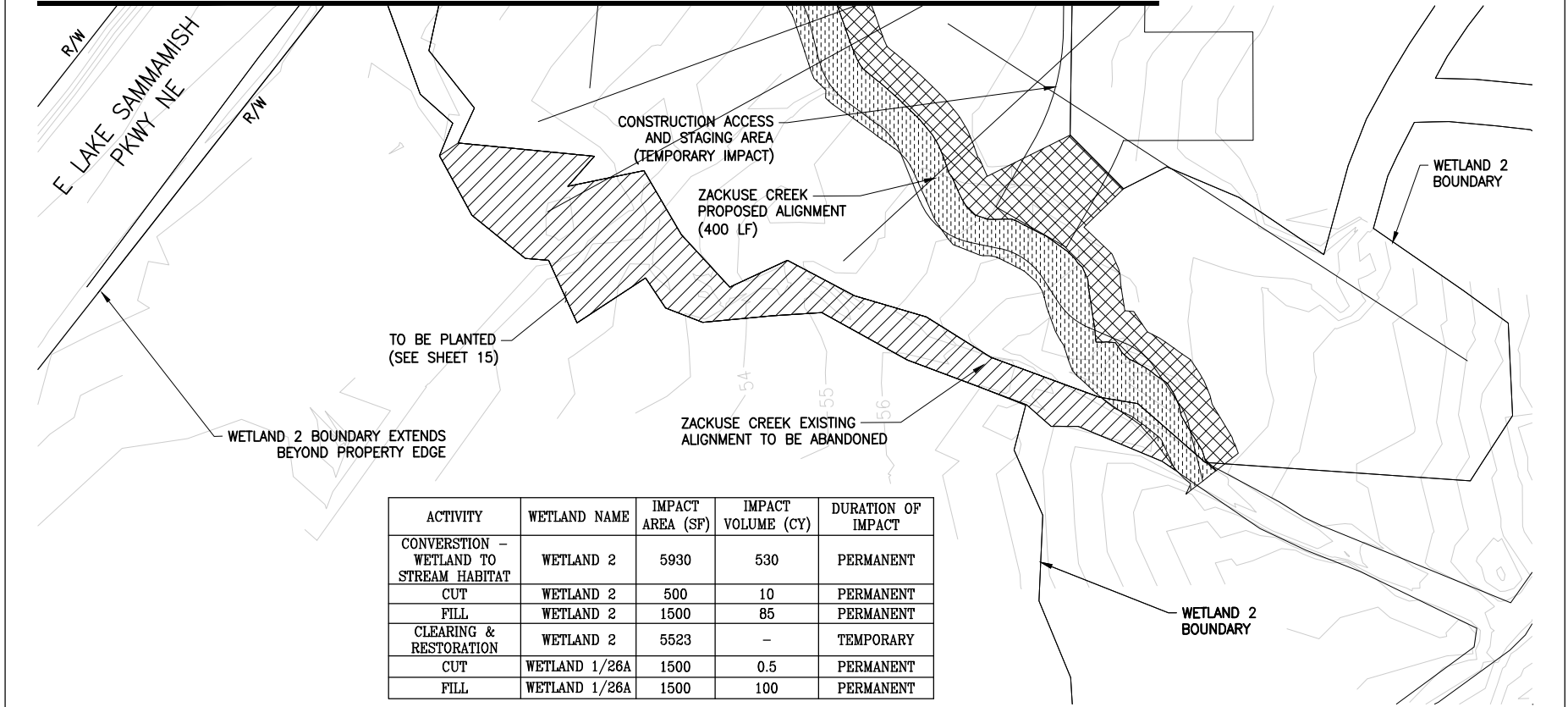

ACTIVITY	WETLAND NAME	IMPACT AREA (SF)	IMPACT VOLUME (CY)	DURATION OF IMPACT
CONVERSION - WETLAND TO STREAM HABITAT	WETLAND 2	5930	530	PERMANENT
CUT	WETLAND 2	500	10	PERMANENT
FILL	WETLAND 2	1500	85	PERMANENT
CLEARING & RESTORATION	WETLAND 2	5523	-	TEMPORARY
CUT	WETLAND 1/26A	1500	0.5	PERMANENT
FILL	WETLAND 1/26A	1500	100	PERMANENT

LEGEND

- WETLAND CONVERSION IN ABANDONED STREAM CHANNEL (6,090 SF)
- NEW STREAM ALIGNMENT - PERMANENT WETLAND CONVERSION (5,930 SF)
- TEMPORARY WETLAND IMPACTS (5,523 SF)
- PERMANENT WETLAND IMPACTS - ROAD RELATED (3,400 SF)
- WETLAND BOUNDARY
- WETLAND BUFFER

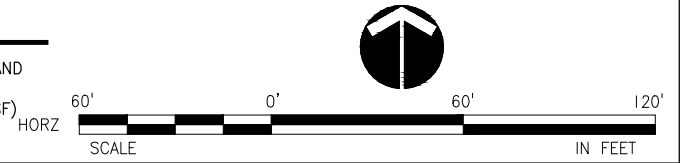

DATE: October 2017

<p>APPLICANT: CITY OF SAMMAMISH</p> <p>REFERENCE #:</p> <p>ADJACENT PROPERTY OWNERS: SEE JARPA ATTACHMENT C</p>	<p>PURPOSE: ENVIRONMENTAL ENHANCEMENT</p> <p>LAT/LONG: 47.6100N / 122.0703W</p> <p>SITE LOCATION ADDRESS: PORTIONS OF SECTION 32, TOWNSHIP 25N, RANGE 06E</p>	<p>PROPOSED PROJECT: ZACKUSE CREEK FISH PASSAGE PROJECT</p> <p>WATER BODY: LAKE SAMMAMISH/ZACKUSE CREEK</p> <p>NEAR: SAMMAMISH</p> <p>COUNTY: KING      STATE: WA</p>
---	---	---